



DOWNER & CO

TRUSTED SINCE 1988

16 Perseus House
Francis Close
Thatcham RG18 3GR

£220,000



Smart Two Double Bedroom, Two Bathroom Top Floor Apartment

Features.

- Top floor apartment
- Smartly presented throughout
- Contemporary design and highly eco-efficient
- Two double bedrooms
- Master bedroom en-suite
- Open plan living/dining/kitchen
- Underfloor heating
- Allocated parking
- ONWARD CHAIN COMPLETE
- 993 years remaining on lease





Approximate Gross Internal Area
65.53 sq m / 705.35 sq ft

Description.

A very smart two double bedroom, two bathroom top floor apartment located on the western fringes of Thatcham close to Henwick Park. The apartment is presented in a cool contemporary design and is highly eco-efficient.

The apartment offers security entry system, communal entrance hall, personal hallway, open-plan living/kitchen/dining room, master bedroom en-suite, further double bedroom, bathroom, underfloor heating and allocated parking.

Lease Details and Service Charges

Lease: 999 years remaining from 2018.

Ground Rent: £252 per annum

Service Charge: £1182 per annum

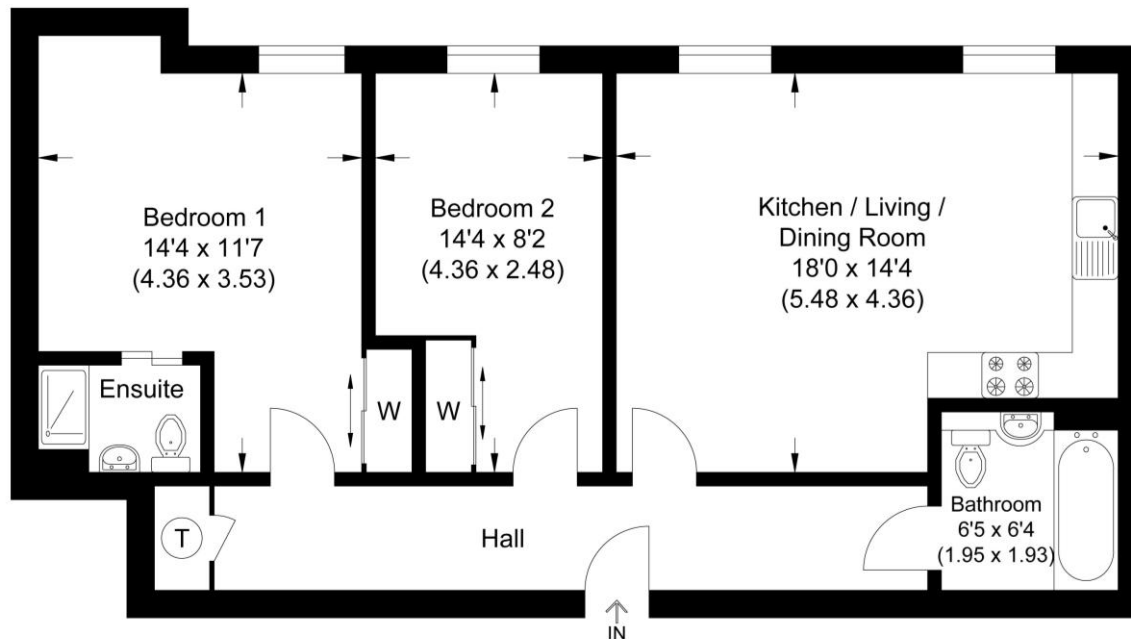

Ground Floor

Illustration for identification purposes only, measurements are approximate, not to scale.



EPC: B

COUNCIL TAX BAND: C

TENURE: LEASEHOLD

For more information on this apartment or to arrange a viewing please call the office on:

01635 523777

Alternatively, visit our website below to view all of the details of this property online.

www.downer.co.uk

Downer & Co Estate Agents
44 Cheap Street
Newbury
Berkshire
RG14 5BX

Important Notice

PROPERTY MISDESCRIPTIONS ACT 1991

The information in this document is indicative and is intended to act as a guide only. These particulars should not be relied upon as accurately describing any of the specific matters described by any order under the Property Misdescriptions Act 1991. This information does not constitute a contract or warranty. The dimensions given on plans are subject to minor variations and are not intended to be used for carpet sizes, appliance sizes or items of furniture. We would like to point out that all photographs are taken with a wide angle lens and any fitted appliances have not been tested.